

Models SE215MJ, SE215NJ and SE220MJ, SE220NJ Integral Type Magnetic Flowmeter (Wafer Type)

Unit :mm
(approx, inch)

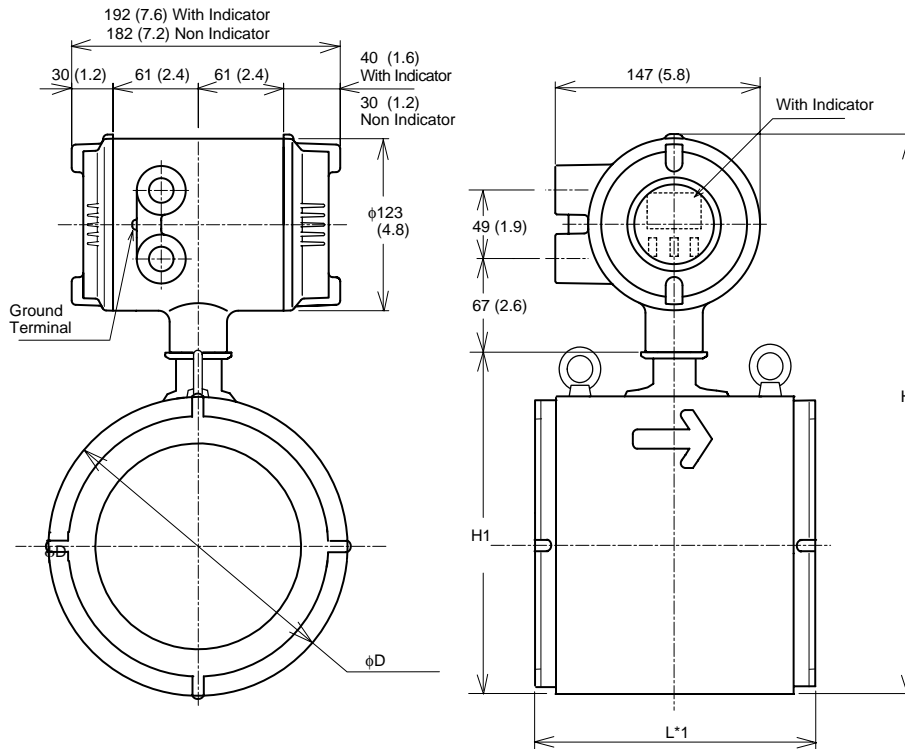

Model		SE215MJ SE215NJ	SE220MJ SE220NJ
Nominal size		150 (6)	200 (8)
Lining		Fluorocarbon PFA	
Face-to-face length	L*1	200 (7.9)	250 (9.8)
Outside diameter	ϕD	218 (8.6)	268 (10.6)
Height	H	404 (15.9)	454 (17.9)
	H1	248 (9.8)	298 (11.7)
Weight kg (lb)*2		16.1 (35.5)	24.2 (53.4)

*1 When no earth ring is selected the face to face length is shorter by approx. 2.0mm (0.08inch).

The face to face length is longer by approx. 34mm (1.34inch) for earth ring(P.T).

The face to face length is longer by approx. 10.0mm (0.40inch) for optional code /FRG.

*2 With Indicator Option : Add 0.22 kg (0.49 lb)

*3 The flow direction is opposite (right to left when facing onto indicator) in case of optional code /CRC.

SD10B1-03E.eps

Terminal symbols	Description
PLS/ALM + -	PULSE/ALARM OUTPUT
CUR + -	
POWER + -	POWER SUPPLY
G	
	EARTH

