

2-wire Inductive Conductivity Measuring system ISC202S [Style: S2, S3] Inductive Conductivity Transmitter

Unit : mm

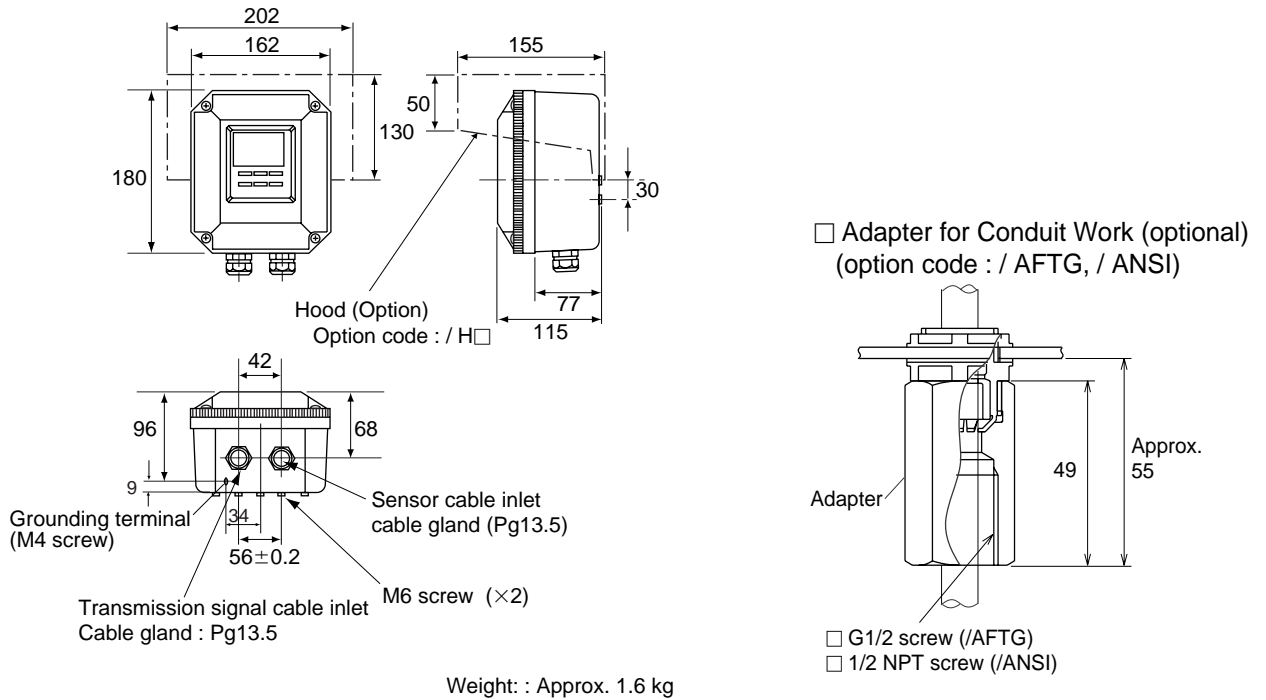

Wiring Diagrams Example of Explosionproof System

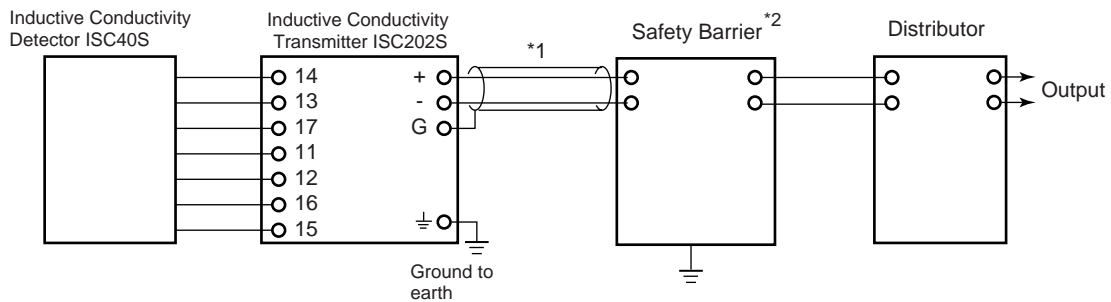

*1 Use two-wire cable with OD (Outside Diameter) of 6 to 12 mm.

*2 For intrinsically safe approval, use the safety barrier certified by the testing laboratories.
In case of non-incendive type (ISC202S-B, -N, -D), the safety barrier is not necessary.

Unless otherwise specified, differences in the dimensions are specified as: General tolerance = ±(Criteria of tolerance class IT18 in JIS B0401 - 1986)/ 2

□ Bracket for Pipe or Wall Mounting (Option code: /U) Weight : : Approx. 0.4 kg

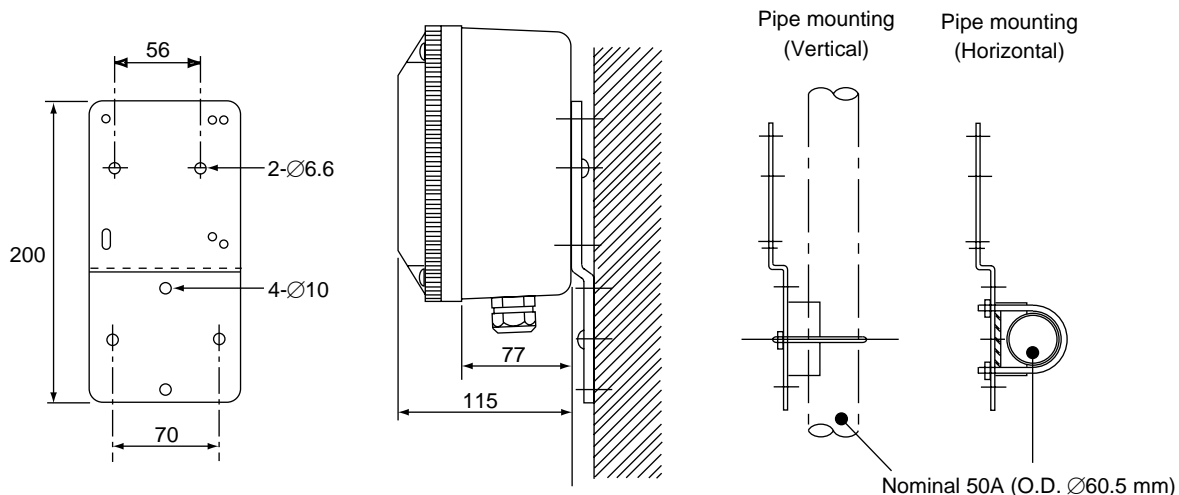

□ Panel Mounting Hardware (Option code : / PM) Weight : : Approx. 0.4 kg

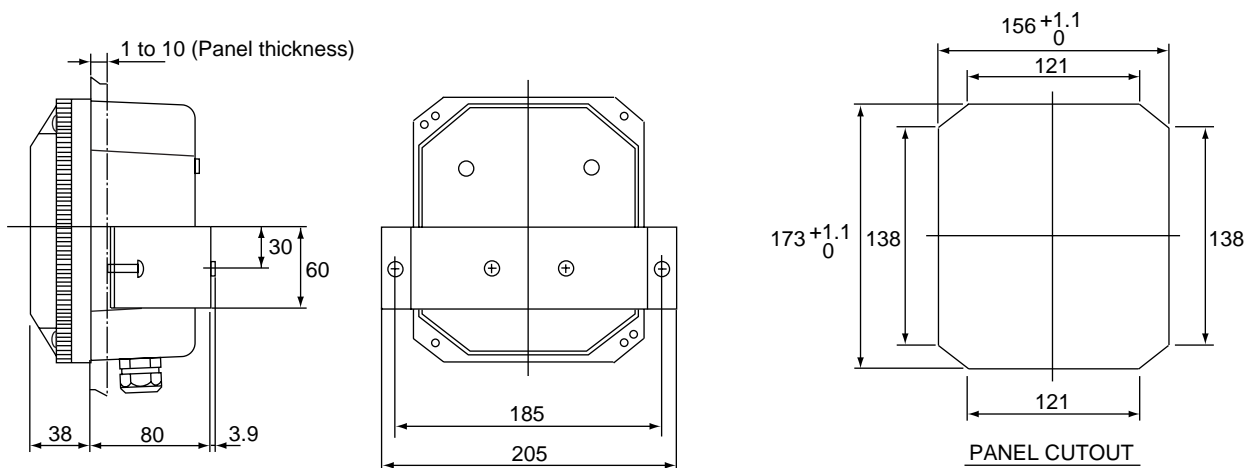

Panel Mounting when using two(2) self-tapping screws

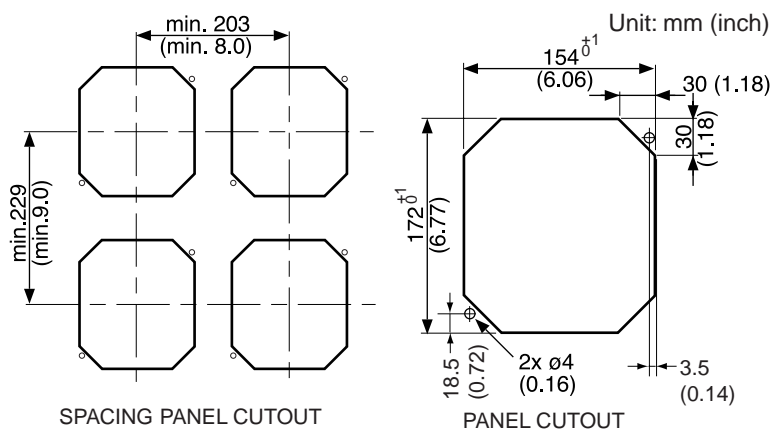

Unless otherwise specified, differences in the dimensions are specified as : General tolerance=(Criteria of tolerance class IT18 in JIS B0401-1986)/2.